

Technical Datasheet
MPP Film Power Capacitors (Cylindrical)
Burst Proof Design
Item Code : YLTCCS-C
Construction:

- Dielectric: Metallized Polypropylene film
- Electrode: Metallized Film
- Connection: Δ
- External Discharge device: Resistor
- Encapsulation: Soft PU resin, NPCB
- Aluminium Container

Terminals:

- Finger Proof terminals (IP 20) with Copper cable

Typical Applications:

- For Power factor correction applications

Features:

- Conforms to IEC 60831-1&2 & IS 13340:2012
- Low dissipation factor
- High insulation resistance
- Naturally air cooled (or forced air cooling)
- Indoor mounting
- NPCB(Non-Polychlorinated biphenyl) compliant

Safety:

- Over pressure disconnecter (Burst Proof)
- Self-healing properties
- Protection: IP 20

Marking / Identification Label

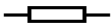
- | | |
|--|-----------------------------------|
| ▪ L&T logo | Rated Frequency |
| ▪ 3 Phase | Serial number |
| ▪ Rated voltage | Rated Kvar |
| ▪ Rated Current | Δ Connection |
| ▪ SH- MPP | |
| ▪ Discharge Device :  | Over pressure Disconnecter \neq |
| ▪ Date of Manufacture | CE Mark |

Delivery Mode

- Single stacking arranged Packing

Technical Datasheet
MPP Film Power Capacitors (Cylindrical)
Burst Proof Design
Electrical Characteristics:

▪ Reference Standard	: IEC:60831-1+2 & IS:13340/41
▪ Rated Kvar	: 1KVAR To 30 KVAR
▪ Terminals (Cu cable connected to)	: 1 KVAR To 5 KVAR - Faston type terminals : 7.50 KVAR To 30 KVAR - Finger proof type terminals
▪ No of Phases	: 1Ø and 3Ø
▪ Capacitance tolerance	: -5 To + 10 %
▪ Rated voltage V_R	: 250Vac To 660Vac
▪ Inrush current I	: Up to 200* I_R
▪ Over Voltage V_{max}	: $V_R * 1.1$ Continuous
▪ Over Current I_{max}	: Up to 1.5 * I_R
▪ Rated Frequency F_R	: 50 / 60 Hz
▪ AC test Voltage terminal to terminal	: 2.15 x V_R ,2s (Routine test) : 2.15 x V_R ,60s (Type test)
▪ AC test Voltage terminal to can	: 3.6 KV AC ,2s
▪ Discharge time	: < 50 V within 60 seconds.
▪ Losses (tan δ)	Dielectric : 0.0002 Total : 0.00045**
▪ Temperature Category	: -10/D
▪ Type of Terminals	: Screw type Finger proof terminals
▪ Mounting Position	: Vertical
▪ Mean Life Expectancy	: Up to 100 000 hrs (Max 5000 switching per year)

**Without Resistor and Cables

Important notes:

1. KVAR ratings and rated voltages can be customized as per customer requirement.
2. We always try hard to improve our products Quality. Thus, the products explained in this Data sheet may change from time to time. The same is true of the corresponding product specifications.
3. Please check the product descriptions and specifications mentioned in this datasheet are still applicable before or when you place an order.
4. Ratings and container dimensions can be changed as per customer requirement

Technical Datasheet
MPP Film Power Capacitors (Cylindrical)
Burst Proof Design

1 KVAR TO 5 KVAR

7.50 KVAR TO 30 KVAR

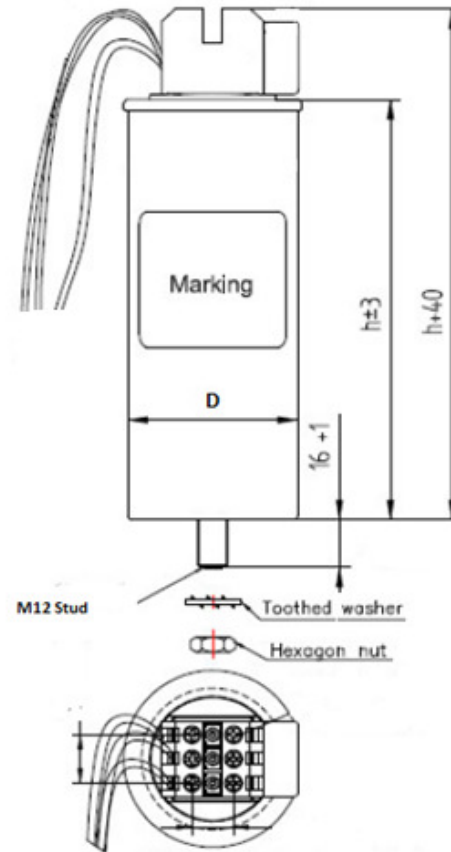
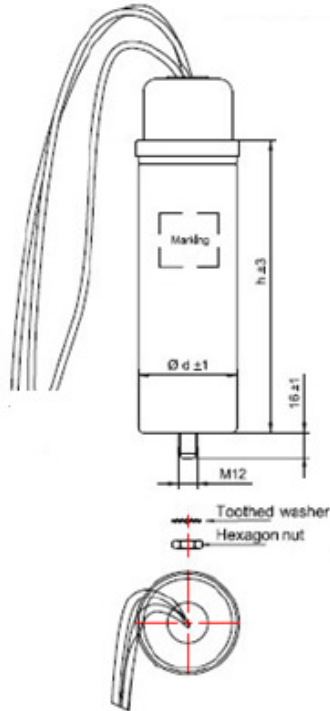

Sr. No.	Cat No.	Voltage (V)	KAVR		Rated Current (A)		Dimensions d x h (mm)
			50Hz	60Hz	50Hz	60Hz	
1	YLTCCS302B2C	440	2.5 KVAR	3.0 KVAR	3.3	3.9	50 x 130
2	YLTCCS305B2C	440	5.0 KVAR	6.0 KVAR	6.6	7.9	63.5 x 155
3	YLTCCS310B2C	440	10.0 KVAR	12.0 KVAR	13.1	15.7	75 x 203
4	YLTCCS315B2C	440	15.0 KVAR	18.0 KVAR	19.7	23.6	75 x 278
5	YLTCCS320B2C	440	20.0 KVAR	24.0 KVAR	26.2	31.5	85 x 278
6	YLTCCS325B2C	440	25.0 KVAR	30.0 KVAR	32.8	39.4	90 x 278
7	YLTCCS330B2C	440	30.0 KVAR	36.0 KVAR	39.4	47.2	100 x 278
8	YLTCCS310M2C	525	10.0 KVAR	12.0 KVAR	11.0	13.2	75 x 278
9	YLTCCS315M2C	525	15.0 KVAR	18.0 KVAR	16.5	19.8	85 x 278
10	YLTCCS320M2C	525	20.0 KVAR	24.0 KVAR	22.0	26.4	90 x 278
11	YLTCCS325M2C	525	25.0 KVAR	30.0 KVAR	27.5	33.0	100 x 278
12	YLTCCS330M2C	525	30.0 KVAR	36.0 KVAR	33.0	39.6	100 x 353